



ASHFORD
BOROUGH COUNCIL

Environmental Permit

**Pollution Prevention and Control Act 1999
The Environmental Permitting
(England and Wales) Regulations 2016**

Permit Reference: LAPPC/ 27

**Address:
St Michaels Service Station
Ashford Road
St Michaels
Tenterden
Kent
TN30 6DD**

Detail	Date
Revised Permit Issued	15 th July 2019

Introductory Note

This introductory note does not form part of your Environmental Permit conditions, however it does provide useful information about the Environmental Permitting Regulations:

The following Permit is issued under Schedule 1 Section 1.2 Part B (d) of the Environmental Permitting (England and Wales) Regulations 2016 (“the EPR”) to operate a scheduled installation carrying out an activity, or activities covered by the description therein to the extent authorised by the Permit.

Conditions within this Permit detail Best Available Techniques (BAT), for the management and operation of the installation, to prevent, or where that is not practicable, to reduce emissions.

In determining BAT, the Operator should pay particular attention to relevant sections of the LAPPC Process Guidance note PG 1/14 (13) and any other relevant guidance.

Techniques include both the technology used and the way in which the installation is designed, built, maintained, operated and decommissioned.

Note that the Permit may require the submission of certain information to the Regulator and in addition, the Regulator has the power to seek further information at any time under Regulation 60 of the EPR Regulations, provided that the request is reasonable.

Public Registers

Information relating to Permits is available on public registers in accordance with the EPR. Certain information may be withheld from the public registers where it is commercially confidential or if it is in the interest of national security to do so.

Variations to the Permit

The Regulator may vary the Permit in the future, by serving a variation notice on the Operator. Should the Operator want any of the conditions of the Permit to be changed, a formal application must be submitted to the Regulator (the relevant forms are available from the Regulator). The Status Log that forms part of this introductory note will include summary details of this Permit, variations issued up to that point in time and state whether a consolidated version of the Permit has been issued.

Transfer of the Permit or part of the Permit

Before the Permit can be wholly or partially transferred to another Operator, an application to transfer the Permit must be made jointly by the existing and proposed Operators. A transfer will not be approved if the Regulator is not satisfied that the proposed Permit holder will be the person having control over the operation of the installation, or will not comply with the conditions of the transferred Permit. In addition, if the Permit authorises the Operator to carry out a specified waste management activity, the transfer will not be approved if the Regulator does not consider the proposed Permit holder to be a ‘fit and proper person’ as required by the EPR.

Talking to us

Please quote the Permit number and the installation address if you contact the Authority about this Permit.

Telephone: 01233 331111

Email: epcomplaints@ashford.gov.uk

In Writing: Environmental Protection, Ashford Borough Council, Civic Centre,
Tannery Lane, Ashford, Kent, TN23 1PL



ASHFORD
BOROUGH COUNCIL

Environmental Permit Reference No: LAPPC / 27

Name and address of person authorised to operate the installation:

**RONTEC Watford Ltd
Meridien House
69 – 71 Clarendon Road
Watford
Hertfordshire
WD17 1DS**

Address of Permitted installation:

**St Michaels Service Station
Ashford Road
St Michaels
Tenterden, Kent
TN30 6DD**

The installation boundary and key items of equipment mentioned in the Permit conditions are shown on the plans attached to this Permit (ref: HZD – 5029 and Site No: 5029)

Activity description:

The above named company is permitted to operate an installation for unloading of petrol into stationary storage tanks and motor vehicle refuelling.

The service station has 3 no. petrol tanks.

Tank 1 unleaded 35,843 litre capacity
Tank 3 super unleaded 17,654 litre capacity
Tank 4 unleaded 26,248 litre capacity

The vents for vapour recovery and the delivery and vapour return hoses are as shown on the attached plan.

Conditions

RONTEC Watford Ltd is authorised to operate the activity at St Michaels Service Station, Ashford Road, St Michaels, Tenterden, Kent, TN30 6DD subject to the following conditions.

Petrol Delivery

1. Vapours displaced by the delivery of petrol into storage tanks shall be returned through a vapour-tight connection line to either the mobile container delivering the petrol or a container on the site.
2. Petrol delivery shall only be carried out using the Stage I petrol vapour recovery system and deliveries shall only be made when the system is fully operational.

Motor Vehicle Refuelling

3. Where the recovered petrol vapour is transferred to a storage tank, the vapour/petrol ratio shall be equal to or greater than 0.95 but less than or equal to 1.05.
4. Where automatic monitoring systems have not been installed a weekly functionality check shall be undertaken to verify the operation of the vapour recovery system.

Incident Reporting

5. In the event of any incident at the site which could have an impact beyond the site boundary, the operator shall notify the council by telephone without delay on 01233 331111 and epcomplaints@ashford.gov.uk

Management

6. A copy of this Permit shall be kept at the permitted installation. All staff who should be aware of its content shall be told where it is kept.
7. All relevant staff shall receive the necessary training and instruction to enable them to comply with the conditions of this Permit.
8. The operator shall notify the council of any changes to the persons nominated in the application as the primary point of contact, and deputy.
9. Maintenance and testing of vapour recovery systems shall be recorded.
10. All records made in compliance with this Permit shall be kept in a written or computer log book or by using some other systematic method, and shall be clear and legible. If any entry is amended, a clear statement of the reason for doing so shall be included. Unless otherwise stated in this Permit, all records required to be taken shall be kept available for inspection for at least 4 years from the date of it being made. A copy of the manufacturer's instructions referred to in this Permit shall be available for inspection on request.

Best Available Techniques

11. The best available techniques shall be used to prevent, or where that is not practicable, reduce emissions from the installation in relation to any aspect of the operation of the installation which is not regulated by any other condition of this Permit.

Process Changes

12. If the operator proposes to make a change in operation of the installation, he must, at least 14 days before making the change, notify the regulator in writing. The notification must contain a description of the proposed change in operation. It is not necessary to make such a notification if an application to vary this Permit has been made and the application contains a description of the proposed change. In this condition 'change in operation' means a change in the nature or functioning, or an extension, of the installation, which may have consequences for the environment.

Right to Appeal

You have the right of appeal against this Permit within 6 months of the date of the decision. The council can tell you how to appeal. You will normally be expected to pay your own expenses during an appeal.

You will be liable for prosecution if you fail to comply with the conditions of this Permit. If found guilty, the maximum penalty for each offence if prosecuted in a Magistrates Court is £50,000 and/or 6 months imprisonment. In a Crown Court it is an unlimited fine and/or 5 years imprisonment.

Our enforcement of your Permit will be in accordance with the Regulators Compliance Code.

Signed: 

Officer: Lynne Cregeen

Position: Environmental Health Practitioner

Date: 15th July 2019

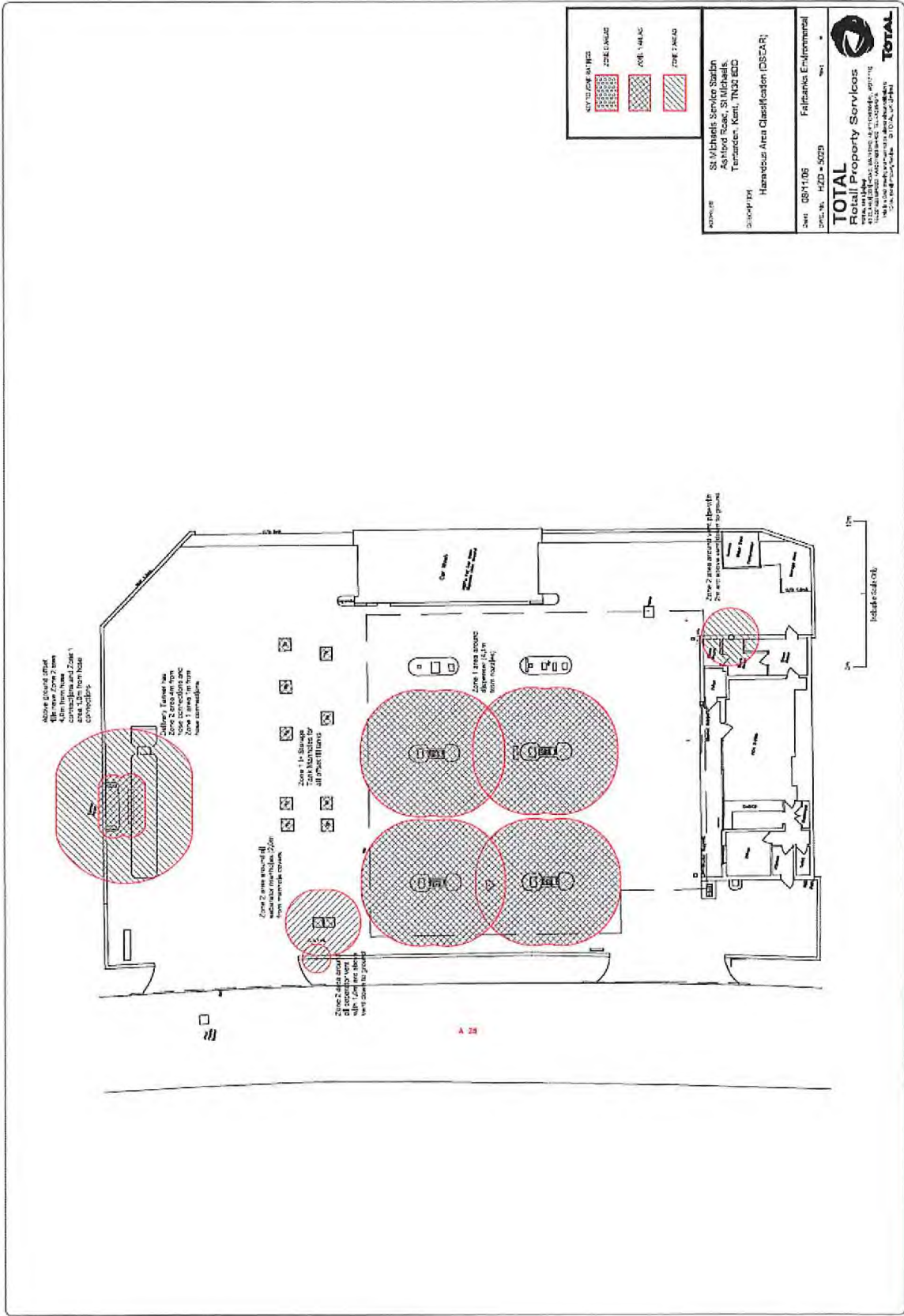



PUMP TO TANK DATA SHEET

RONTEC WATFORD LIMITED TEL: 01923694198.

		1	2	3	4	5	6	7	8	9	10	11	12	13	14	15	16	17	18
L1	UNL				UNL														
L2	UNL				D														
L3	UNL				D														
L4	UNL				D														
R1	SUL				UNL														
R2	UNL				D														
R3	UNL				D														
R4	D				SD														

NOZZLE GRADE ALLOCATION: Standing at the pump head end of the dispenser looking along the length of the dispenser cabinet then, with L = left hand side & R = right hand side: L1 or R1 is the furthest nozzle to the pump control head and L4 or R4 is the furthest nozzle from the pump control head.

For single nozzle pump dispensers show grade at position L1 only.

PUMP AND TANK INFORMATION

TANK No.	TANK CAPACITY (L @ 25% LITRES)	TANK AGE OF TANK (YEAR)	LINING INFORMATION		GRADE
			SINGLE OR DOUBLE SKIN	TANK LINING	
1	33843		SINGLE	N/A	UNL
2	33843		SINGLE	N/A	D
3	17564		SINGLE	N/A	SUL
4	20248		SINGLE	N/A	UNL
5	17564		SINGLE	N/A	D
6	20247		SINGLE	N/A	D
7	17520		SINGLE	N/A	SD

VAPOUR RECOVERY: For stage 2 vapour recovery - collection tank for vapour recovery to be identified on 'pump to tank information' table above by adding note in 'remarks' column for the applicable tank to read 'COLLECTS STAGE 2 VAP'.

PUMP INFORMATION

TANK No.	PUMP NUMBERS SUPPLIED	PUMP MAKE & TYPE	REMARKS
1	1,2,3,6	TOKHEM OS10E	RE-PUMP SEPT 2014
2	1,2,3,6	TOKHEM OS10E	RE-PUMP SEPT 2014
3	1,2,3,6	TOKHEM OS10E	RE-PUMP SEPT 2014
4	3,4,7,8	TOKHEM OS10E	RE-PUMP SEPT 2014
5	7,8	TOKHEM OS10E	RE-PUMP SEPT 2014
6	3,4	TOKHEM OS10E	RE-PUMP SEPT 2014
7	3,4,7,8	TOKHEM OS10E	RE-PUMP SEPT 2014
8			
9			
10			

GAUGE SYSTEM: T16136 R
PRODUCED BY: AJ BAYLIS

Site name: ST MICHAEL'S SERVICE STATION
Site address: ASHFORD ROAD, ST MICHAELS
TENTERDEN, TN30 6DD

Site No.: 5029
Issue date: 11TH SEPTEMBER 2014

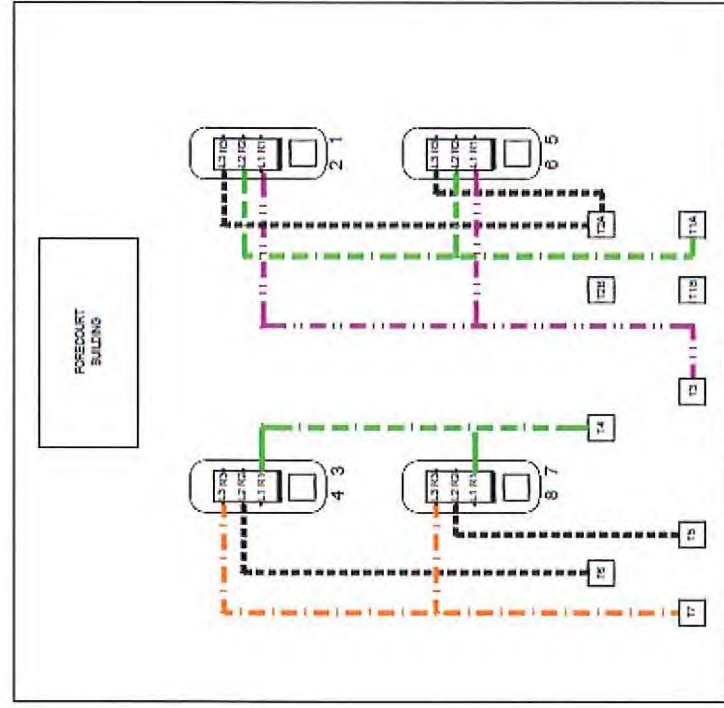

SCHEMATIC LAYOUT DIAGRAM
Not to scale

DIAGRAM LINE KEY

Green line	UNL
Purple line	SUL
Red line	D
Orange line	SD

Abbrev.

Lines shown are indicative of suction line fuel grades and show the tank to pump dispenser NOZZLE position only, and relate to the nozzle position shown on the nozzle label. They do not show the actual positions for dispenser suction line nozzle or needed refer to the pump initiation drawing.